

# PRODUCT INFORMATION PACKET

**marathon®**  
Motors

Model No: 145TTFR5307  
Catalog No: C236  
3,3600,TEFC,145TC,3/60/230/460  
Other Purpose



Regal and Marathon are trademarks of Regal Beloit Corporation or one of its affiliated companies.

©2018 Regal Beloit Corporation, All Rights Reserved. MC017097E

**REGAL**



## Nameplate Specifications

|                            |           |                        |            |
|----------------------------|-----------|------------------------|------------|
| Output HP                  | 3 Hp      | Output KW              | 2.24 kW    |
| Frequency                  | 60 Hz     | Voltage                | 230/460 V  |
| Current                    | 7.6/3.8 A | Speed                  | 3480 rpm   |
| Service Factor             | 1.15      | Phase                  | 3          |
| Efficiency                 | 84 %      | Duty                   | CONTINUOUS |
| Insulation Class           | B         | Design Code            | B          |
| KVA Code                   | K         | Frame                  | 145TC      |
| Enclosure                  | TEFC      | Overload Protector     | NOT        |
| Ambient Temperature        | 40 °C     | Drive End Bearing Size | 6205       |
| Opp Drive End Bearing Size | 6203      | UL                     | Recognized |
| CSA                        | Y         | CE                     | Y          |
| IP Code                    | 43        |                        |            |

## Technical Specifications

|                       |                 |                       |                 |
|-----------------------|-----------------|-----------------------|-----------------|
| Electrical Type       | SQ CAGE IND RUN | Starting Method       | ACROSS THE LINE |
| Poles                 | 2               | Rotation              | REV             |
| Mounting              | ROUND           | Motor Orientation     | HORIZONTAL      |
| Drive End Bearing     | BALL            | Opp Drive End Bearing | BALL            |
| Frame Material        | ROLLED STEEL    | Shaft Type            | T               |
| Overall Length        | 13.37 in        | Frame Length          | 8.06 in         |
| Shaft Diameter        | .88 in          | Shaft Extension       | 2.12 in         |
| Assembly/Box Mounting | F1 ONLY         |                       |                 |
| Outline Drawing       | A-100105-806    | Connection Diagram    | A-EE7308        |

100105

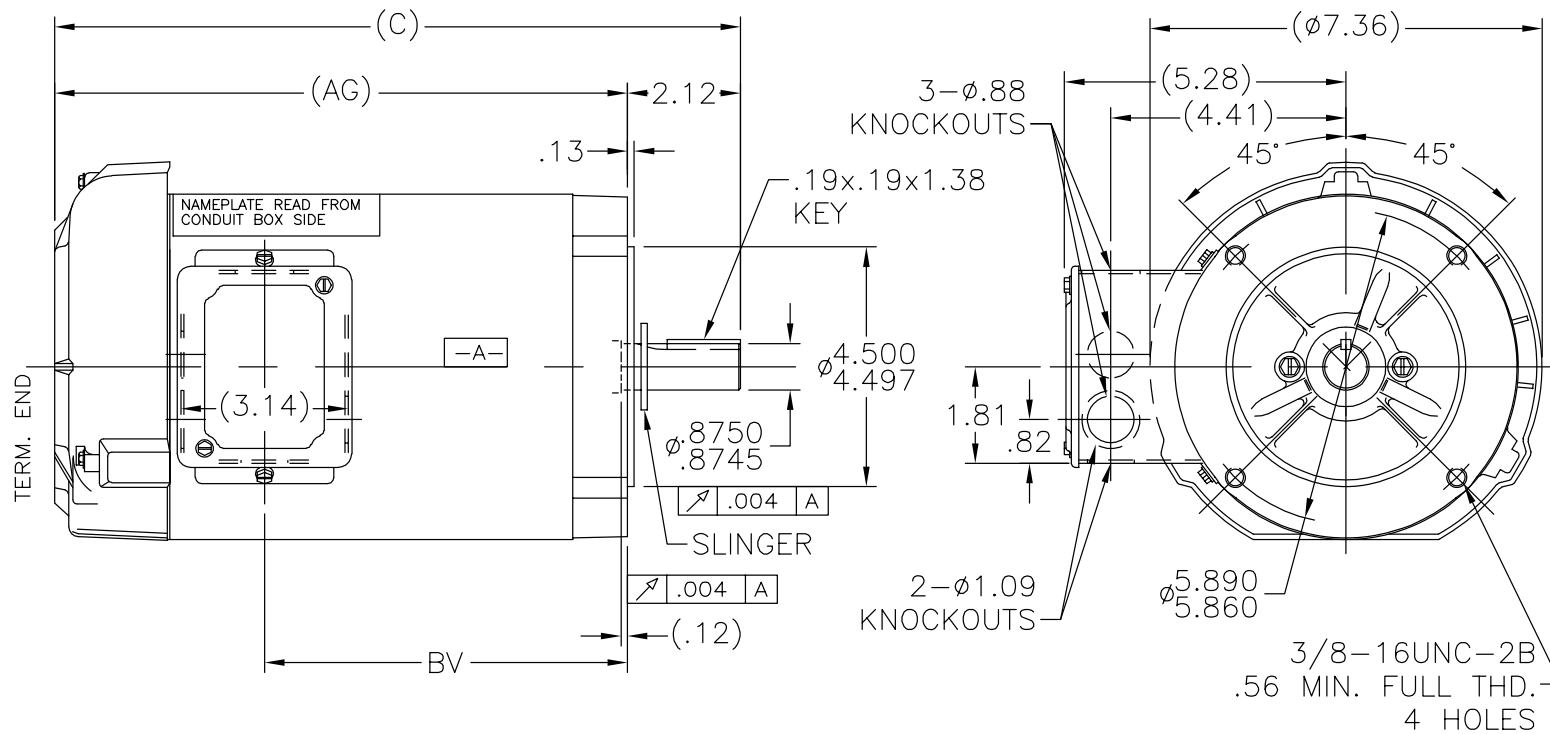

| DASH | FR.  | C     | AG    | BV   | DASH | FR.  | C     | AG    | BV   |
|------|------|-------|-------|------|------|------|-------|-------|------|
|      |      |       |       |      | 806  | 140T | 13.37 | 11.25 | 7.31 |
| 656  | 140T | 11.87 | 9.75  | 5.81 | 856  | 140T | 13.87 | 11.75 | 7.81 |
| 706  | 140T | 12.37 | 10.25 | 6.31 | 906  | 140T | 14.37 | 12.25 | 8.31 |
| 756  | 140T | 12.87 | 10.75 | 6.81 | 956  | 140T | 14.87 | 12.75 | 8.81 |

|  |   |                |     |                                |                 |                      |
|--|---|----------------|-----|--------------------------------|-----------------|----------------------|
| 6  | REMOVED NAMEPLATE NOTE PER ECO-0077123    | PST 05/05/15   | SM  | TOLERANCES<br>UNLESS SPECIFIED |                 | DRAWN SMC 08-14-1991 |
| 5  | NOTE SAID, "METAL NAMEPLATE READ FROM..." | RJW 01-03-2006 | ML  | DEC.                           | INCHES          | CHK ML 08-14-1991    |
| 4  | RE-ISSUED: CLARIFIED "C" & "AG" DIM.      | ERH 06-16-2003 | ML  | .X                             | $\pm .1$        | APPD GK 08-14-1991   |
| 3  | CORRECTED BV IN TABLE WAS BS CN 29200-683 | CTO 03-04-2003 | ML  | .XX                            | $\pm .03$       | SCALE 1=3            |
| 2  | CORRECTED CONDUIT BOX KNOCKOUTS           | ML 01-14-1992  |     | .XXX                           | $\pm .005$      | REF                  |
| 1  | REDRAWN ON CADD & DASH 656 ADDED          | SMC 08-14-1991 |     | .XXXX                          | $\pm .0005$     | FMF                  |
| NO.  | REVISION                                  | BY & DATE      | CHK | ANG                            | $\pm 7'30"$     | PREV                 |
| THIS DRAWING IN DESIGN AND DETAIL IS OUR PROPERTY AND MUST NOT BE USED EXCEPT IN CONNECTION WITH OUR WORK ALL RIGHTS OF DESIGN AND INVENTION ARE RESERVED THIS IS AN ELECTRONICALLY GENERATED DOCUMENT - DO NOT SCALE THIS PRINT |   |                |     | RFP                            | CAD FILE 100105 | SIZE A               |
|  |   |                |     | DIST WP                        |                 | DRAWING NO. 100105   |
|  |   |                |     |                                |                 | PAGE OF 6            |
|  |   |                |     |                                |                 | REV. 6               |

**REGAL**™ Regal Beloit America, Inc.

TITLE OUTLINE  
140 FR. - TEFC 3 $\phi$

MAT'L.

FINISH



| NO.  | REVISION                                       | BY & DATE      | CHK | ANG   | TOLERANCES<br>UNLESS SPECIFIED | DEC.    | INCHES          | DRAWN RM | 11/20/1990               |
|--|--|----------------|-----|-------|--------------------------------|---------|-----------------|----------|--------------------------|
|  |  |                |     |       |                                |         |                 |          |                          |
| 5  | CHG TO REGAL LOGO                              | SL 09/10/2015  | AB  |       |                                |         |                 | CHK      | ML 11/21/1990            |
| 4  | REVISED IEC NOTATIONS                          | MSG 11/15/2011 | CMN | .X    | ±.1                            |         |                 | APPD     | SAS 04/24/2003           |
| 3  | ADDED IEC NOTATIONS... (U1), (V1) ETC. MU95194 | MSG 5/10/2010  | MJS | .XX   | ±.02                           |         |                 | SCALE    | 1=1                      |
| 2  | ADDED THE OPTIONAL CORD CONNECTION MU46318     | RDH 04/24/2003 | DRS | .XXX  | ±.005                          |         |                 | REF      |                          |
| 1  | REDRAWN  | RM 11/20/1990  |     | .XXXX | ±.0005                         |         |                 | FMF      |                          |
|  |  |                |     |       | ±7'30"                         |         |                 | PREV     |                          |
| THIS DRAWING IN DESIGN AND DETAIL IS OUR PROPERTY AND MUST NOT BE USED EXCEPT IN CONNECTION WITH OUR WORK ALL RIGHTS OF DESIGN AND INVENTION ARE RESERVED THIS IS AN ELECTRONICALLY GENERATED DOCUMENT - DO NOT SCALE THIS PRINT |  |                |     |       |                                | RFP     | CAD FILE ee7308 | SIZE     | DRAWING NO. PAGE OF REV. |
|  |  |                |     |       |                                | DIST WP |                 | A        | EE7308 5                 |